

# KINTEK



SPECIAL TOOLHOLDERS



SONDER-WERKZEUGHALTER



СПЕЦИАЛЬНЫЕ РЕЗЦЕДЕРЖАТЕЛИ



PORTEOUTILS SPECIAUX



PORTAUTENSILI SPECIALI



专用刀柄

## BIGLIA TOOLHOLDERS



## BIGLIA

B301/445/470/501(Y-S)/510/545/550/565/650/658  
1200/446/465/745/765 - B750/1250 16 ST.

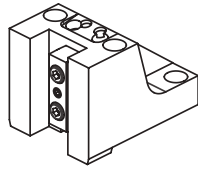

128-41524  
128-41525 (25x25 mm)

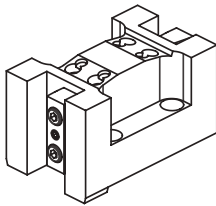

128-41527

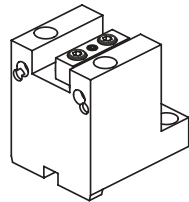

128-31515

Face and O.D.  
cutting holder

Face and O.D.  
cutting holder

Face and O.D.  
cutting holder

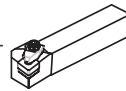

Qualified tool  
20x20 mm

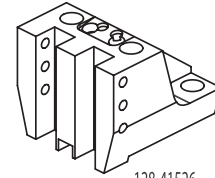

128-41526

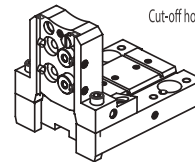

Cut-off holder

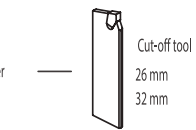

Cut-off tool  
26 mm  
32 mm

128-11566 (26 mm)  
128-11567 (32 mm)

### ACCESSORIES

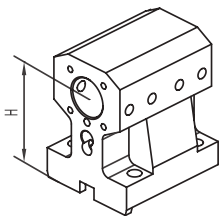

128-21538 H=80  
128-21540 H=100

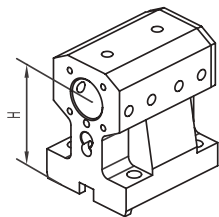

128-21539 H=80  
128-21541 H=100

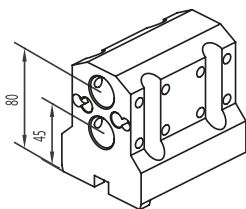

128-21542

Toolholder  
for boring bar

Ø32 mm

Combi toolholder  
for boring bar  
and insert drill

Ø32 mm

Toolholder  
for boring bar

2xØ25 mm

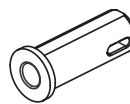

Drill socket

114-33208 <MT1>  
114-33209 <MT2>

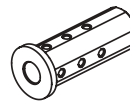

Boring bar sleeve

115-63260 (Ø8 mm)  
115-63261 (Ø10 mm)  
115-63211 (Ø12 mm)  
115-63212 (Ø16 mm)  
115-63213 (Ø20 mm)

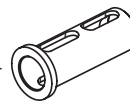

Boring bar sleeve

115-63214 (Ø25 mm)



Throw-away drill socket

165-63325 (Ø16 mm)  
165-63326 (Ø20 mm)  
165-63327 (Ø25 mm)

### CONNECTION

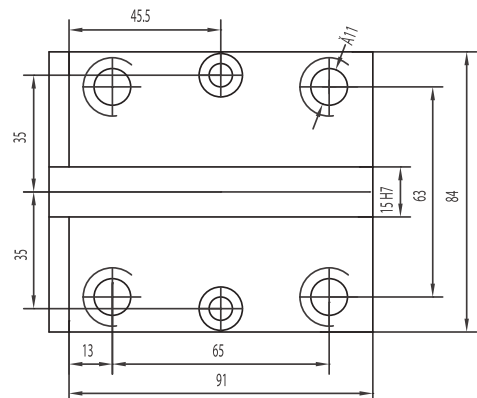



**HEAD OFFICE**

KINTEK S.R.L. - MAPPANO - TORINO - ITALY



**NEW PRODUCTION PLANT**

A.M.T S.R.L. - CASELLE T.SE - TORINO - ITALY



**MAIN PRODUCTION PLANT**

KINTEK TOOLING KFT - BEKESCSABA - HUNGARY

**KINTEK**

VIA GORETTA 88/G - 10072 MAPPANO  
FRAZIONE DI CASELLE (TO) - ITALIA  
Tel. +39.011.9968065 - Fax +39.011.9965662  
<http://www.kintek.it> - e-mail: [info@kintek.it](mailto:info@kintek.it)